

Pacific ENCOUNTER



2,600 GUESTS, LOWER BERTHS | 12 GUEST DECKS
290 M IN LENGTH | 108,865 GROSS TONNAGE

ROOM GRADING

SUITE

- GS:** DECK 11
Access to Byron Beach Club
- OS:** DECK 11
Access to Byron Beach Club
- PA:** DECK 11, 10
Access to Byron Beach Club
- PB:** DECK 10
Access to Byron Beach Club
- SV:** DECK 10, 9, 8
Access to Byron Beach Club
- S8m:** DECK 9
Two Bedroom Suite
Access to Byron Beach Club

MINI-SUITE

- M1:** DECK 9
Access to Byron Beach Club
- MA:** DECK 9
- MB:** DECK 9
- MD:** DECK 9
- ME:** DECK 8

BALCONY

- BI:** DECK 10
- B2:** DECK 10, 9, 8
- BA:** DECK 11
- BB:** DECK 12, 11
- BC:** DECK 14, 12
- BD:** DECK 11, 10
- BE:** DECK 12, 11, 10
- BF:** DECK 14, 12, 8

OCEANVIEW

- OI:** DECK 8
Obstructed view
- OC:** DECK 5
Obstructed view
- OF:** DECK 5
Obstructed view
- OP:** DECK 12
Porthole
- OV:** DECK 8
Obstructed view
- OW:** DECK 8
Obstructed view
- OY:** DECK 8
Obstructed view

INTERIOR

- I1:** DECK 11, 10
- IA:** DECK 11, 10
- IB:** DECK 12, 11, 10, 9
- IC:** DECK 14, 12, 8, 5
- ID:** DECK 11, 10, 9
- IE:** DECK 12, 11, 10, 9, 8
- IF:** DECK 14, 12, 8, 5

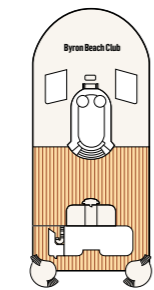

DECK 16

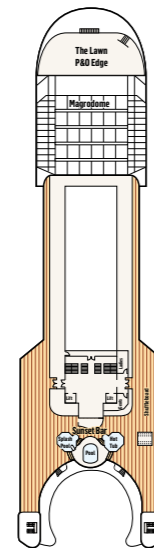

DECK 17/18

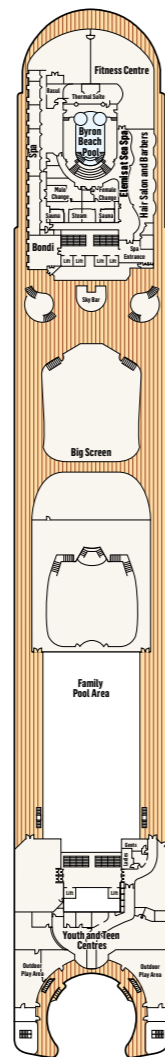

DECK 15

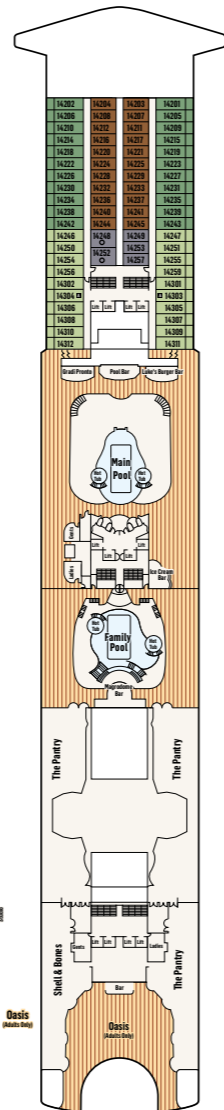

DECK 14

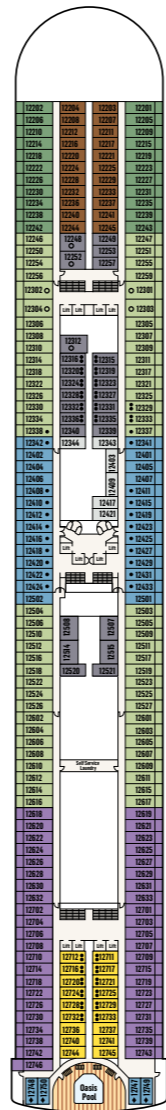

DECK 12

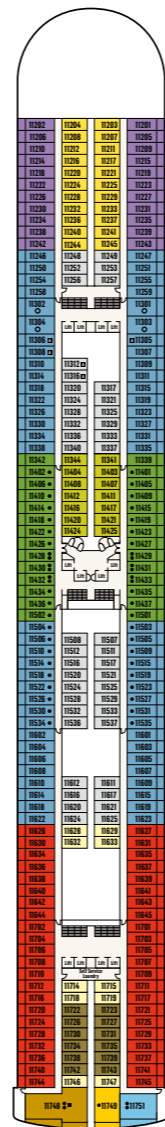

DECK 11

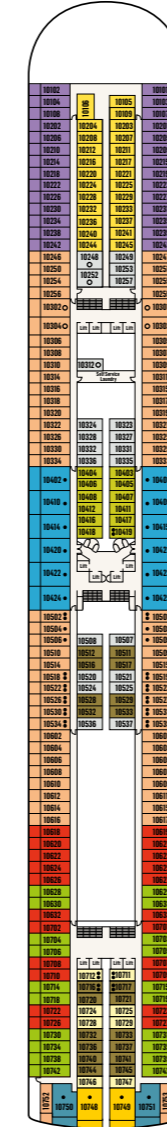

DECK 10

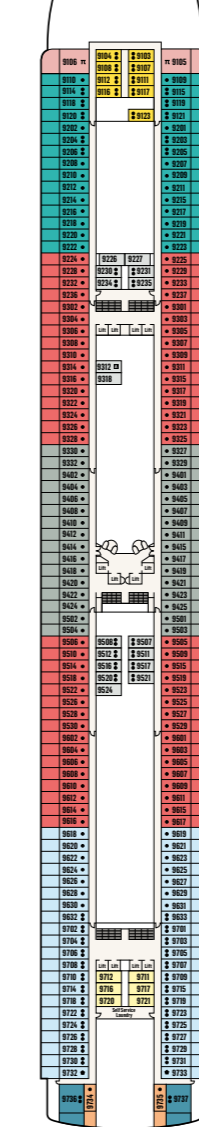

DECK 9

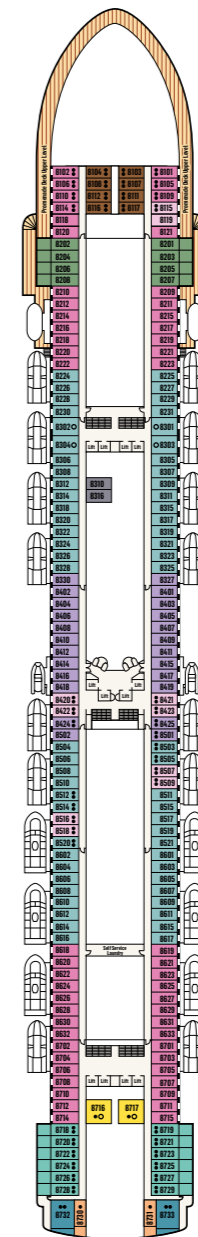

DECK 8

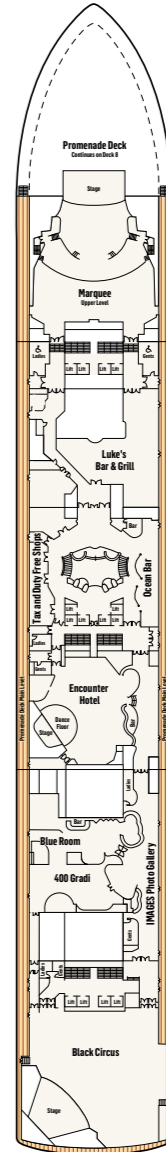

DECK 7

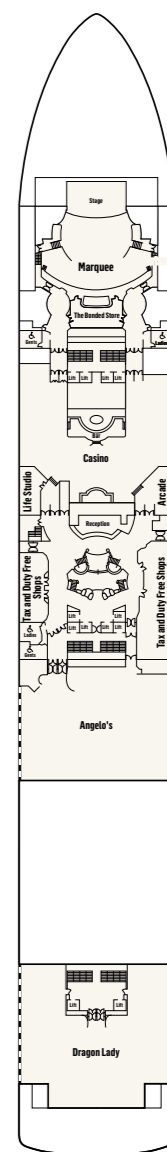

DECK 6

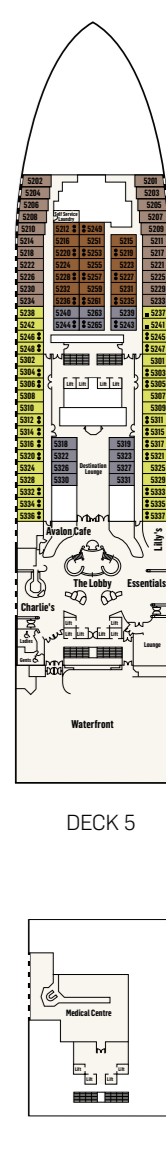

DECK 5

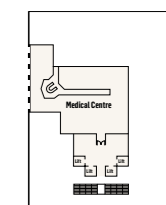

DECK 4

- Third berth available
- Third or fourth berth available
- ⌘ Connecting rooms with private balcony; will accommodate 6-8 persons
- ◆ Porthole
- ◆ Twin beds only
- Wheelchair-accessible room
Includes wider doorways (to accommodate a wheelchair), no thresholds into the bathroom and more handrails around the bathroom. Please check at time of booking.
- Fixed queen-size bed, cannot be converted to twin beds
- ▲ Ambulatory Accessible stateroom
Accessible features may include grab bars and/or fold down shower seats. These rooms are not wheelchair accessible.

Note: Cots are available in selected rooms and are not available in any interior & oceanview quad rooms. Contact P&O Cruises for more information. Deck plans are for illustration purposes only. They are not to scale and are subject to change. Bedding configuration of three- and four-berth rooms may vary, and it may not be possible to have queen bedding when the third and fourth beds (upper bunks) are in use. Please check with your travel agent or our Customer Service team at the time of booking for bedding configuration.

Please note Public spaces, configuration and room grading of Pacific Encounter may change.

DECK 17/18
DECK 16
DECK 14
DECK 11
DECK 9
DECK 7
DECK 5

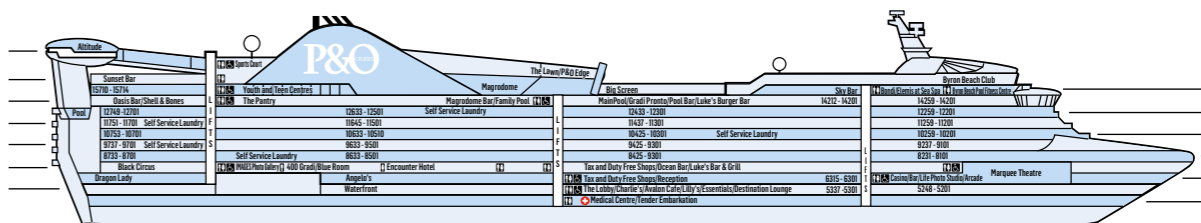

DECK 15
DECK 12
DECK 10
DECK 8
DECK 6
DECK 4

MEET THE FLEET

FORWARD

AFT